

# *ILC*

- Inline Centrifugal Fan
- With External Rotor

## SPECIFICATION

---

### Sizes

125, 150, 200, 250, 315mm diameter

### Fan Performance

The fan is of low noise and high static efficiency design. The impeller is designed to give excellent performance characteristic with high static pressure development with out stall

### Impellers

ILC2-ILC5: The impellers are manufactured from black composite material incorporating metal back plates

ILC6 is of metal construction.

Impellers are balanced according to ISO1940.

### Motors

Asynchronous external rotor motors. Motor enclosure to feature IP44 protection . Motor winding insulation are to incorporate thermal class 155 as standard. Motor bearings are to be of maintenance free ball bearing design. Auto-reset thermal contacts are provided as standard.

### Casing

Casing of the fans are of galvanised steel, with round spigot connection to suit either flexible duct or galvanised steel ductwork.

### Test Procedures

Performance Date – Established from tests in accordance with ISO5801:1997

Sound levels – Established from tests in accordance with ISO3745

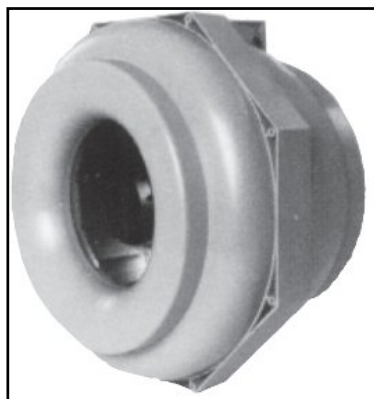

Woods ILC inline centrifugal fan

# Inline Centrifugal Fan

ILC2-125

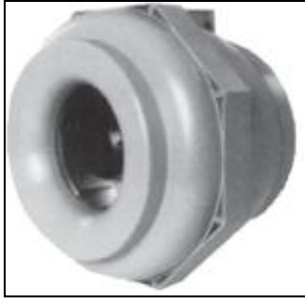

**Impeller**

Size 125 mm  
 Type Backward Curve  
 Material Steel  
 Motor finish Powder Coating RAL7032

**Motor**

Type External Rotor  
 IP Rating 44  
 Insulation Class 155  
 Power 0.05 Kw  
 Power Supply 230V/1PH/50Hz  
 Speed 2540  
 FLC 0.29  
 Capacitor 2 µF  
 Control RE1.5, 5 Step Controller  
 Protection Thermal Contacts

**Fan**

Case Steel  
 Weight 2.5 Kg  
 Max. Temp 50 °C

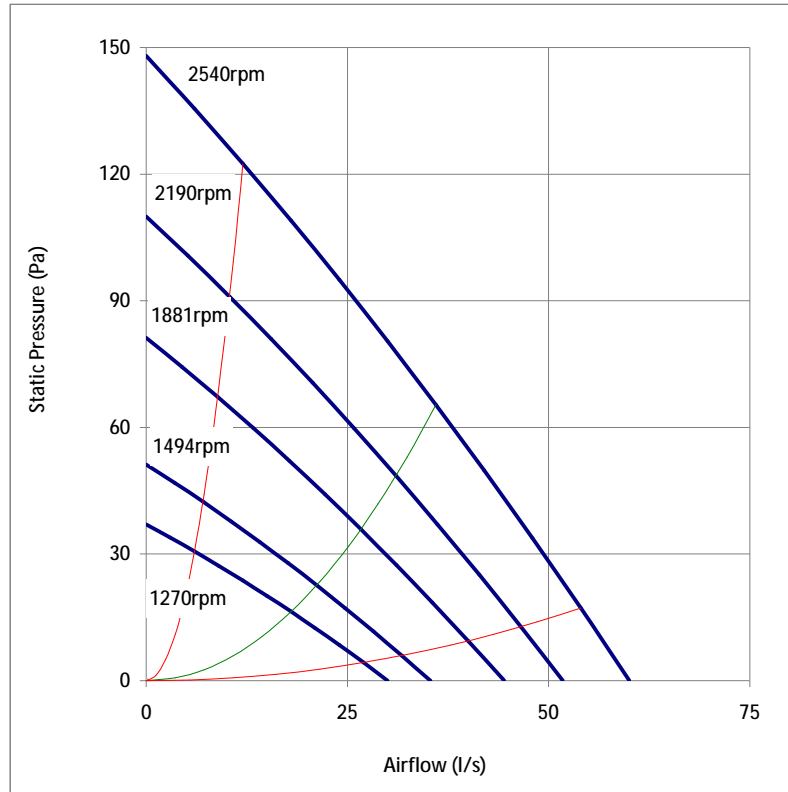

Speed (rpm)	Peak Pressure (Pa)	Peak Power (kw)	Motor Running Voltage (V)	Sound Power Level SWL dB re 1pw								Sound Pressure Level dB at 3 meters
				63	125	250	500	1k	2k	4k	8k	
2540	148	0.05	230	64	60	59	52	46	44	35	33	27
2190	110	0.03	200	61	57	56	49	43	41	32	30	24
1881	81	0.02	170	57	53	52	45	39	37	28	26	20
1494	51	0.01	130	52	48	47	40	34	32	23	21	15
1270	37	0.01	110	49	45	44	37	31	29	20	18	12

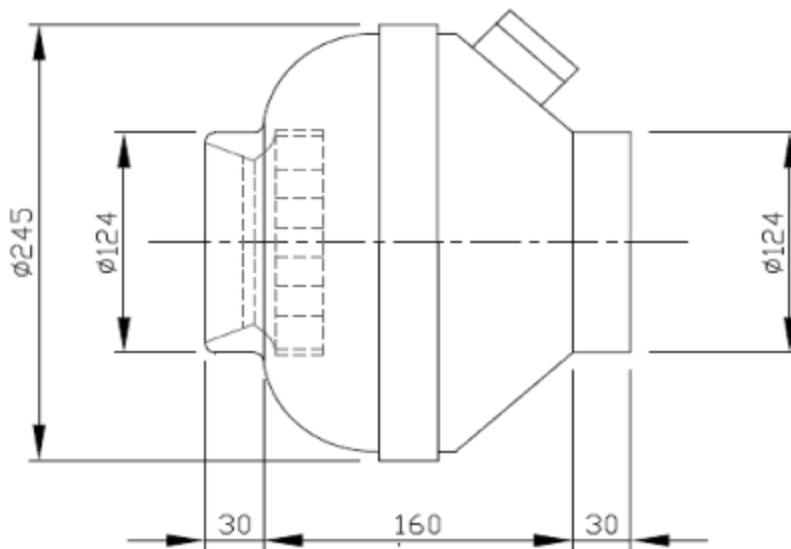

# Inline Centrifugal Fan

ILC3-150



### Impeller

Size 150 mm  
 Type Backward Curve  
 Material Steel  
 Motor finish Powder Coating RAL7032

### Motor

Type External Rotor  
 IP Rating 44  
 Insulation Class 155  
 Power 0.07 Kw  
 Power Supply 230V/1PH/50Hz  
 Speed 2520  
 FLC 0.31  
 Capacitor 2 µF  
 Control RE1.5, 5 Step Controller  
 Protection Thermal Contacts

### Fan

Case Steel  
 Weight 2.5 Kg  
 Max. Temp 50 °C

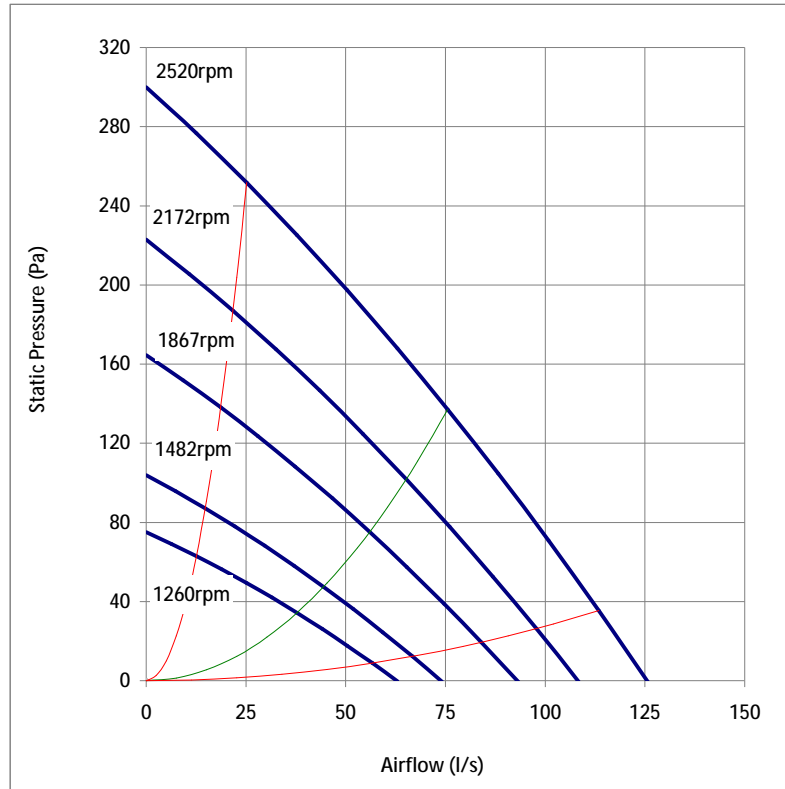

Speed (rpm)	Peak Pressure (Pa)	Peak Power (kw)	Motor Running Voltage (V)	Sound Power Level SWL dB re 1pw								Sound Pressure Level dB at 3 meters
				63	125	250	500	1k	2k	4k	8k	
2520	300	0.07	230	67	63	63	56	49	46	38	36	36
2172	223	0.04	200	64	60	60	53	46	43	35	33	33
1867	165	0.03	170	60	56	56	49	42	39	31	29	29
1482	104	0.01	130	55	51	51	44	37	34	26	24	24
1260	75	0.01	110	52	48	48	41	34	31	23	21	21

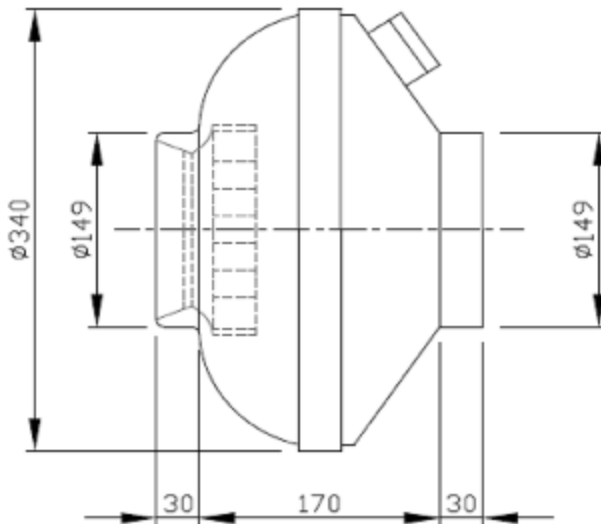

# Inline Centrifugal Fan

ILC4-200



### Impeller

Size 200 mm  
 Type Backward Curve  
 Material Steel  
 Motor finish Powder Coating RAL7032

### Motor

Type External Rotor  
 IP Rating 44  
 Insulation Class 155  
 Power 0.12 Kw  
 Power Supply 230V/1PH/50Hz  
 Speed 2550  
 FLC 0.51  
 Capacitor 2.5  $\mu$ F  
 Control RE1.5, 5 Step Controller  
 Protection Thermal Contacts

### Fan

Case Steel  
 Weight 3 Kg  
 Max. Temp 50 °C

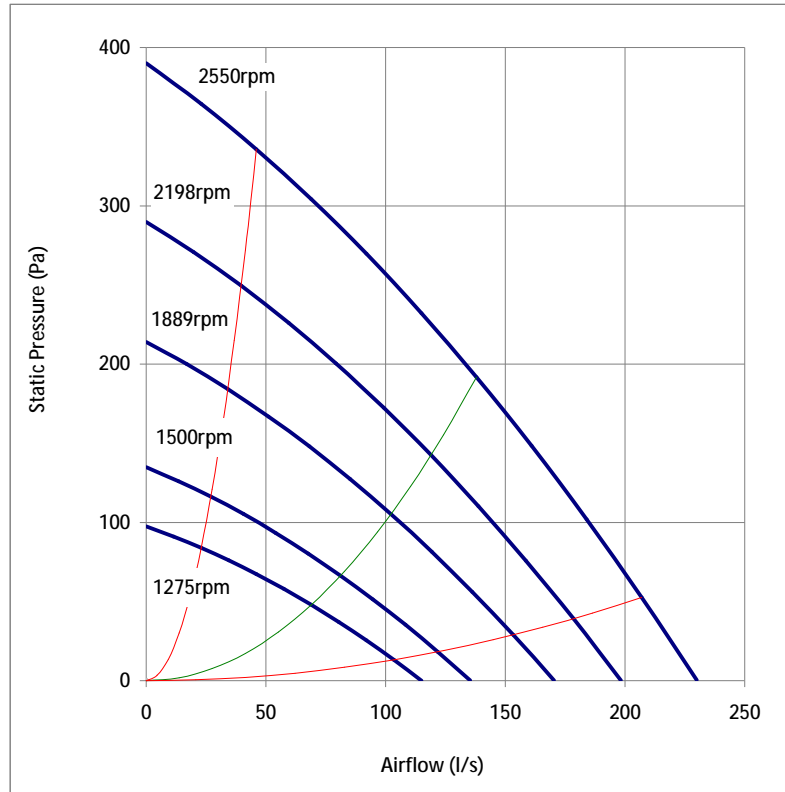

Speed (rpm)	Peak Pressure (Pa)	Peak Power (kw)	Motor Running Voltage (V)	Sound Power Level SWL dB re 1pw								Sound Pressure Level dB at 3 meters
				63	125	250	500	1k	2k	4k	8k	
2550	390	0.12	230	70	65	65	61	58	57	53	46	43
2198	290	0.08	200	67	62	62	58	55	54	50	43	40
1889	214	0.05	170	63	58	58	54	51	50	46	39	36
1500	135	0.02	130	58	53	53	49	46	45	41	34	31
1275	98	0.02	110	55	50	50	46	43	42	38	31	28

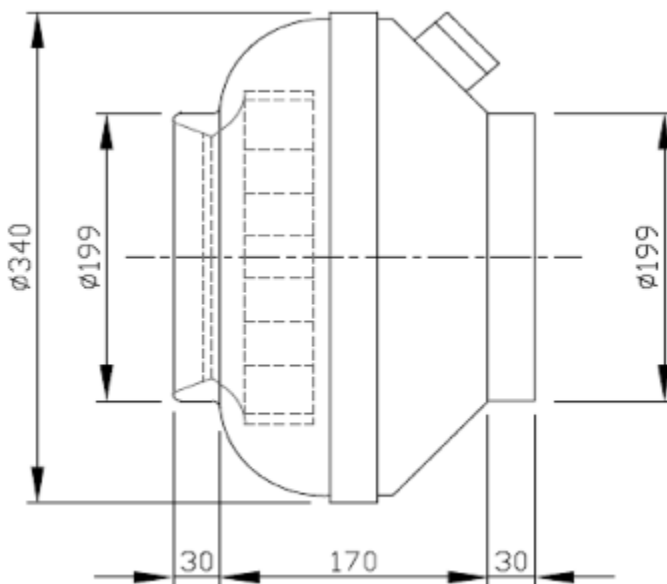

# Inline Centrifugal Fan

ILC5-250



### Impeller

Size 250 mm  
 Type Backward Curve  
 Material Steel  
 Motor finish Powder Coating RAL7032

### Motor

Type External Rotor  
 IP Rating 44  
 Insulation Class 155  
 Power 0.17 Kw  
 Power Supply 230V/1PH/50Hz  
 Speed 2550  
 FLC 0.75 mA  
 Capacitor 3 µF  
 Control RE1.5, 5 Step Controller  
 Protection Thermal Contacts

### Fan

Case Steel  
 Weight 3.5 Kg  
 Max. Temp 50 °C

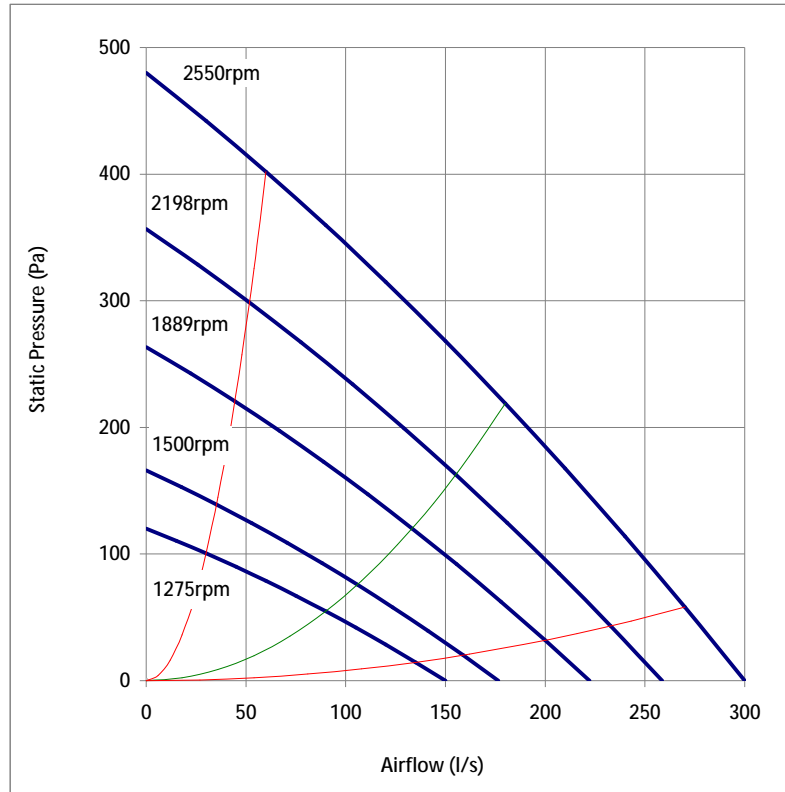

Speed (rpm)	Peak Pressure (Pa)	Peak Power (kw)	Motor Running Voltage (V)	Sound Power Level SWL dB re 1pw								Sound Pressure Level dB at 3 meters
				63	125	250	500	1k	2k	4k	8k	
2550	480	0.17	230	77	69	69	63	62	61	57	49	46
2198	357	0.11	200	74	66	66	60	59	58	54	46	43
1889	263	0.07	170	70	62	62	56	55	54	50	42	39
1500	166	0.03	130	65	57	57	51	50	49	45	37	34
1275	120	0.02	110	62	54	54	48	47	46	42	34	31

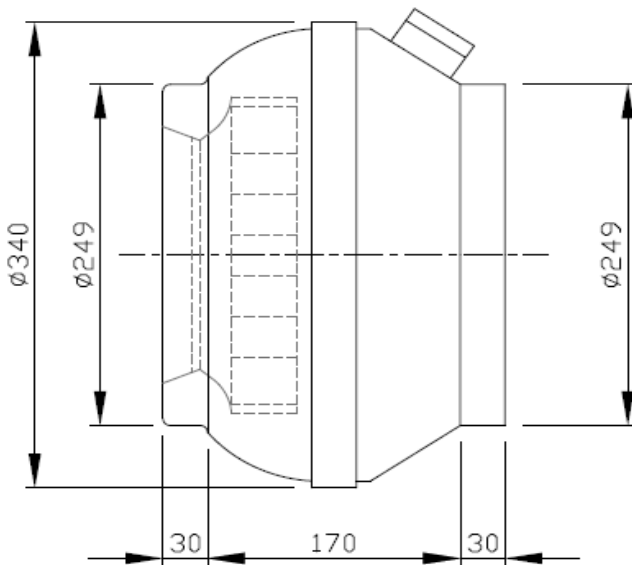

# Inline Centrifugal Fan

ILC6-315



**Impeller**

Size 315 mm  
 Type Backward Curve  
 Material Steel  
 Motor finish Powder Coating RAL7032

**Motor**

Type External Rotor  
 IP Rating 44  
 Insulation Class 155  
 Power 0.28 Kw  
 Power Supply 230V/1PH/50Hz  
 Speed 2300  
 FLC 1.20 A  
 Capacitor 4 µF  
 Control RE1.5, 5 Step Controller  
 Protection Thermal Contacts

**Fan**

Case Steel  
 Weight 4 Kg  
 Max. Temp 50 °C

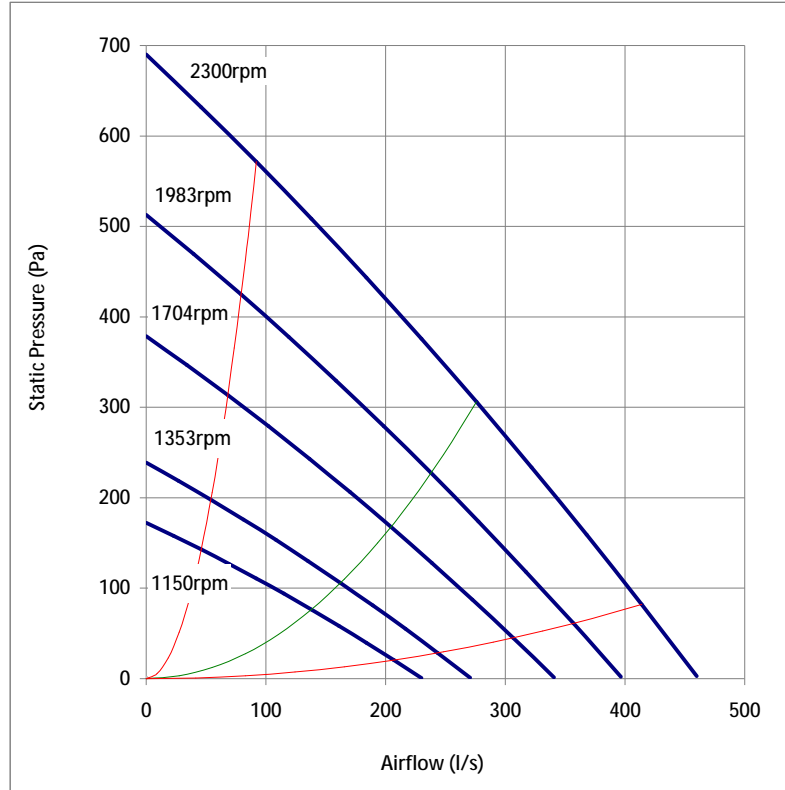

Speed (rpm)	Peak Pressure (Pa)	Peak Power (kw)	Motor Running Voltage (V)	Sound Power Level SWL dB re 1pw								Sound Pressure Level dB at 3 meters
				63	125	250	500	1k	2k	4k	8k	
2300	690	0.28	230	79	71	71	65	65	63	59	52	49
1983	513	0.18	200	76	68	68	62	62	60	56	49	46
1704	379	0.11	170	72	64	64	58	58	56	52	45	42
1353	239	0.06	130	67	59	59	53	53	51	47	40	37
1150	173	0.04	110	64	56	56	50	50	48	44	37	34

